



## AKRAPOVIC RACING & EVOLUTION TWIN EXHAUST SYSTEM for the SUZUKI GSX-R1000 (2007-2008)

Congratulations on purchasing an Akrapovic exhaust system. Please read these installation instructions carefully. If you have any trouble installing the system please contact your authorized dealer!

### IMPORTANT INFORMATION

#### Exclusion of Certain Liability

1. The manufacturer, importer or dealer shall not be liable for any incidental damage including personal injury or any other damages caused by improper installation or operation of the Akrapovic exhaust system. When installing the Akrapovic exhaust system be careful that the exhaust system does not touch other parts sensitive to high temperature.
2. Akrapovic makes no representation or warranties with regard to damage caused by the improper installation, use and maintenance of the Akrapovic exhaust system. The warranty is limited to defects recognized by our technical department and to normal use, and excludes items subject to normal wear (gaskets and damping wool). The guarantee is void in case of accident, modification, improper or competition use.
3. Do not attempt to install the Akrapovic exhaust system on a motorcycle for which it was not made or tested by Akrapovic.
4. When the exhaust system gets very hot during operation, be careful not to burn yourself on the exhaust system or parts which are in direct contact with it, even when the motor is not running. Also protect other people, especially children, from the injuries mentioned above.
5. In some cases Akrapovic exhaust system kits contain chemical products (ceramic anti-seizing grease; bolt sealant). Handle with care, do not inhale or swallow. Avoid excessive contact with skin, eyes or mucous membranes. Keep out of reach of children.
6. Technical specifications of Akrapovic exhaust systems and related products subject to change without notice.

#### Trademarks

The Akrapovic Exhaust System Technology logo is a registered trademark of Akrapovic d.d.

#### Akrapovic website

Information about Akrapovic exhaust systems and related products is available on the Akrapovic website at:

<http://www.akrapovic.com/>

#### Copyright

No part of the Akrapovic exhaust system or its documentation may be reproduced or distributed in any form or by any means without the prior written authorization of the Akrapovic company.

© Akrapovic, d.d. All rights reserved.

#### Symbols

The following symbols are used throughout these installation instructions:



 **USE BOLT SEALANT;** Apply 3 to 4 small drops of bolt sealant onto the cleaned and degreased threads before tightening bolts. **WARNING! Avoid contact with skin, eyes and mucous membranes. Do not inhale fumes. Keep out of the reach of children.**

 **USE ANTI-SEIZING GREASE (white tube);** Prevents seizing, corrosion and excessive wear between the titanium components of your exhaust system. **WARNING! Avoid eye contact. Avoid excessive skin contact. Keep out of the reach of children.**

 **USE ANTI-SEIZE LEAD-FREE COPPER PASTE (black tube);** Provides trouble-free and long-lasting protection against seizing, corrosion and rusting of bolts, threaded ends, nuts, joints, etc. Also protects against vibration, wear and impact. **WARNING! Avoid eye contact. Avoid excessive skin contact. Keep out of the reach of children.**

## **INSTALLATION INSTRUCTIONS**

**⚠ BEFORE INSTALLING CHECK SCHEMATIC OF THE EXHAUST SYSTEM!**

**! IF ANY ITEMS IN THE AKRAPOVIC EXHAUST SYSTEM PACKAGE ARE MISSING PLEASE CONTACT YOUR AUTHORIZED DEALER. KEEP THE SCHEMATIC FOR FUTURE REFERENCE.**

**! THESE INSTALLATION INSTRUCTIONS MUST BE READ CAREFULLY IN ORDER TO ENSURE PROPER INSTALLATION AND OPERATION OF THE AKRAPOVIC EXHAUST SYSTEM.**

**! THE EXHAUST SYSTEM CAN BE EXTREMELY HOT. ALLOW THE MOTORCYCLE TO COOL DOWN BEFORE BEGINNING INSTALLATION.**

**⚠ WE ADVISE YOU TO LEAVE INSTALLATION TO A QUALIFIED SERVICEMAN. IMPROPER INSTALLATION MAY RESULT IN A SHORTER LIFETIME OF THE EXHAUST SYSTEM AND/OR DAMAGE TO THE MOTORCYCLE.**



T-handle 10mm wrench  
T-handle 12mm wrench  
T-handle swiveling 10mm wrench  
T-handle 4mm three hexagon key wrench  
T-handle 6mm three hexagon key wrench  
T-handle swiveling 6mm three hexagon key wrench  
Combination 10mm wrench  
Combination 12mm wrench  
Combination 13mm wrench  
Combination 17mm wrench  
Screwdriver for headless slotted screws  
Screwdriver for cross head  
Spring puller

### **REMOVAL OF STOCK EXHAUST SYSTEM:**

1. Put the motorcycle on a side stand, we recommend a racing stand. Make sure, that surface is solid and flat.
2. Unscrew the lower cowling bolts (**Figure 1, 2**) and the bolts from the metal clamps at the muffler - collector joints and muffler sub-frame brackets. Remove the muffler. Perform the process on both sides of the motorcycle (**Figure 3, 4, 5**).



*Figure 1*



*Figure 2*



*Figure 3*



*Figure 4*



*Figure 5*

3. Remove and reverse the metal collars on both muffler brackets (**Figure 6, 7, 8, 9**).



*Figure 6*



*Figure 7*



*Figure 8*



*Figure 9*

4. Remove the lower and the middle parts of the cowling (Figure 10, 11, 12, 13).



Figure 10



Figure 11



Figure 12



Figure 13

5. Untighten the bolt of the stock metal clamp (Figure14). Unscrew the lambda sensor (Figure15). Unscrew all bolts from stock collector brackets (Figure16) , and remove the collector (Figure17). Unscrew and remove the both collector brackets (Figure 18, 19).



Figure 14



Figure 15



Figure 16



Figure 17



Figure 18



Figure 19

6. Unscrew and remove the exhaust valve cables bracket (Figure 20, 21). Unscrew and remove the riders seat and fuel-tank side panels (Figure 22, 23, 24). Unscrew, lift and secure the fuel-tank (Figure 25, 26). Unscrew the exhaust valve servo motor and completely remove the cables (Figure 27, 28, 29). **WARNING! Do not disconnect the electrical installation of the servo motor!**



Figure 20

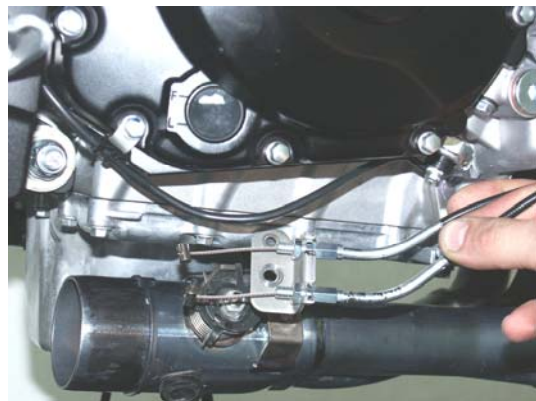

Figure 21

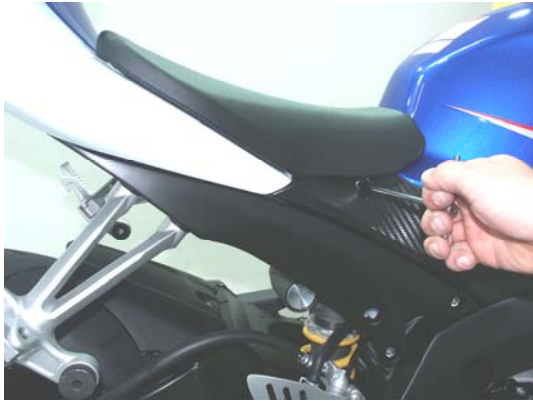

Figure 22



Figure 23



Figure 24



Figure 25



Figure 26



Figure 27



Figure 28



Figure 29

7. Unscrew and remove the stock servo motor wheel and bracket (Figure 30, 31). **WARNING: do not turn the the servo motor wheel with force or the servo motor could be damaged. Hold the servo wheel in place with pliers when unscrewing!** Correctly position and tighten the Akrapovic servo motor bracket and rotation limiter to specified torque (Figure 32, 33). **WARNING: do not turn the servo motor wheel with force or the servo motor could be damaged. Hold the the rotation limiter in place with pliers when tightening!** Retighten the servo motor on its place on the motorcycle using stock bolts (Figure 34, 35). Reattach the fuel-tank, fuel-tank side panels and riders seat in the reverse order from the order in which they were removed.



Figure 30



Figure 31

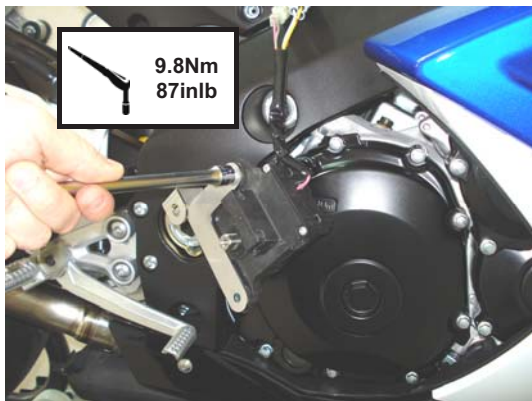

Figure 32

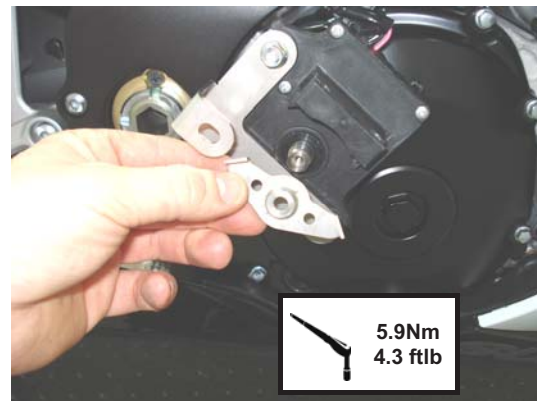

Figure 33



Figure 34

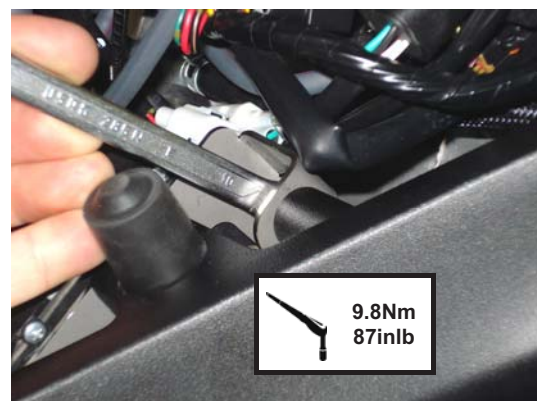

Figure 35

8. Unscrew and partially remove the water and oil coolers (Figure 36, 37, 38). **WARNING! Do not disconnect the cooling or oil system tubes!**



Figure 36



Figure 37



Figure 38

9. Unscrew the bolts from the header tube flanges and remove stock headers ; Make sure not to damage the cooling fins ; Leave the stock gaskets in the exhaust ports! (Figure 39, 40).



Figure 39



Figure 40



**INSTALLATION OF THE AKRAPOVIC RACING OR EVOLUTION TWIN EXHAUST SYSTEM:**

1. Set up the sleeves together with the flanges and springs; make sure they are correctly oriented (**Figure 41, 42**). Tighten the flanges (to specified torque) ; make sure not to damage the cooling fins.



*Figure 41*



*Figure 42*

2. Insert the header tubes properly and attach the springs; **WARNING!** make sure, that **springs pull the headers all the way into the sleeves – use rubber mallet if necessary to tap the connections into place!** make sure not to damage the cooling fins (**Figure 43, 44**). Make sure the header tubes are not touching the engine, other tubes, electrical installations etc.



*Figure 43*



*Figure 44*

3. Make sure the collectors are correctly oriented. Slide the collectors onto the header tubes and attach the springs **WARNING!** make sure, that springs pull the collectors all the way onto the headers – use rubber mallet if necessary to tap the connections into place! (Figure 45, 46). For Evolution exhaust only: coat the interior side of the input bushes of the titanium collector with Akrapovic ceramic anti-seizing grease (white tube). Reattach both coolers and coolers bracket in the reverse order from the order in which they were removed ; (Tightening torque for both coolers bolts: 9.8Nm / 7ftlb).



Figure 45



Figure 46

4. Slide the twin link onto the collectors, attach the springs and tighten the twin links bracket using stock bolt, washer and Akrapovic nut (Figure 47, 48, 49). For Evolution exhaust only: coat the interior side of the input bushes of the titanium twin link with Akrapovic ceramic anti-seizing grease (white tube). Tighten the lambda sensor (Figure 50). Slide both link pipes onto the twin link and attach the springs (Figure 51, 52). For Evolution exhaust only: coat the interior side of the input bushes of the titanium link pipes with Akrapovic ceramic anti-seizing grease (white tube). Correctly position the carbon-fiber clamps and slide them onto the mufflers - bear in mind the left offset of the carbon-fiber clamp viewed from the rear for right side and the right offset for the left side. WARNING: open the clamps slightly wider than the diameter of the outer sleeves of the mufflers – do not scrape them along the mufflers outer sleeves! (Figure 53). For Evolution exhaust only: coat the interior side of the input of the mufflers with Akrapovic ceramic anti-seizing grease (white tube). Position the mufflers correctly and slide them onto the outlet side of the link pipes (Figure 54). Position and attach the springs (Figure 55). Tighten the bolts on the carbon-fiber clamp/stock muffler bracket joints (Figure 56, 57). Make sure the link pipes or mufflers are not touching the frame and other parts. Attach the cowlings in the reverse order from the order in which they were removed. (Figure 58).

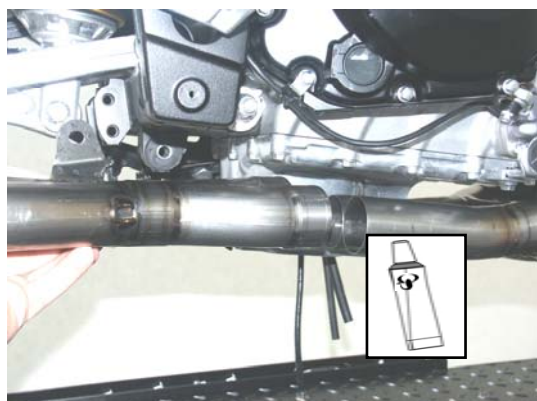

Figure 47



Figure 48



Figure 49

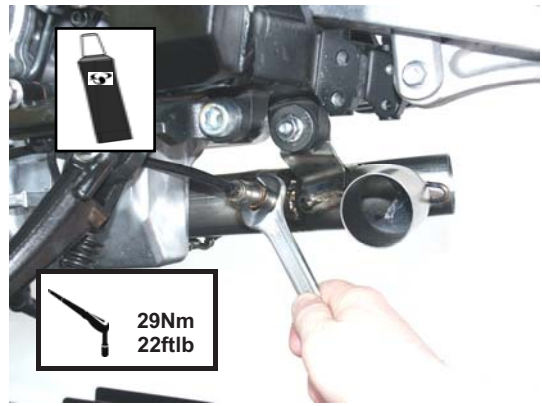

Figure 50

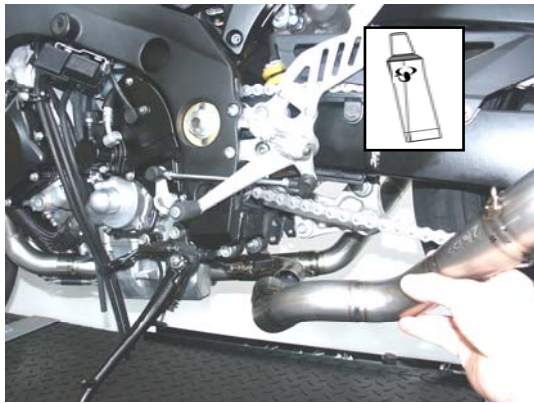

Figure 51



Figure 52



Figure 53



Figure 54



Figure 55



Figure 56

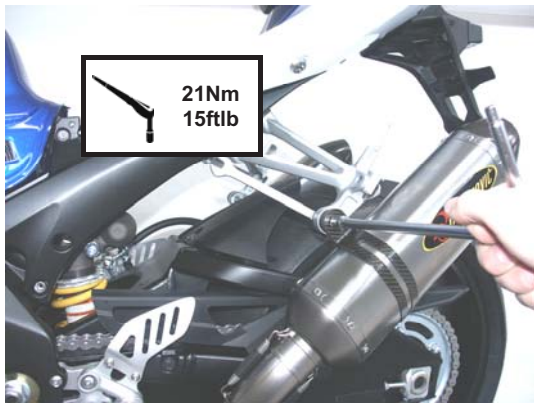

Figure 57

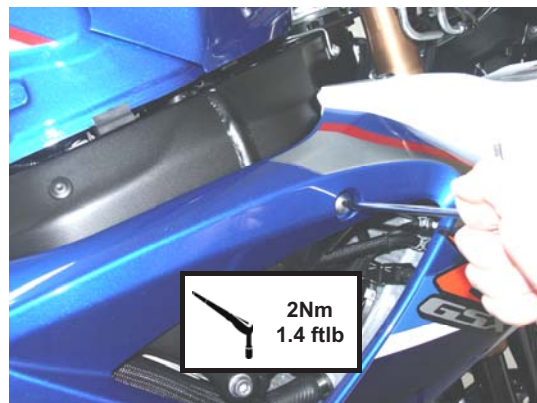

Figure 58

**final installation:**

1. Clean grease spots:
  - a. Mufflers – carbon-fiber outer sleeve: use a soft dry cloth.
  - b. Mufflers – titanium outer sleeve: use a soft cloth sprayed with a multi-purpose spray lubricant (WD-40 or equivalent).
  - c. Mufflers – carbon-fiber outlet cap: use a soft dry cloth.
  - d. RACING - stainless steel link pipes, twin link, collectors and header tubes: use a soft cloth sprayed with a contact cleaner, then wipe with a soft dry cloth
  - e. EVOLUTION - titanium link pipes, twin link, collectors and header tubes : use a soft cloth sprayed with a multi-purpose spray lubricant (WD-40 or equivalent).

Cleaning will prevent spots from burning onto the surface. Do not use aggressive chemical cleaners, because they can damage the sticker.

Position of the correctly installed Akrapovic **RACING OR EVOLUTION TWIN** system (Figure 59).



Figure 59

2. Check the operation of the brakes and suspension. Make sure all the bolts are sufficiently tightened. In case the exhaust system touches the cowling or other parts repeat the adjustment of the exhaust system or contact your authorized dealer.

**! IT IS NORMAL IF WHITE SMOKE COMES OUT OF THE MUFFLER ON FIRST OPERATION.**

**! DO NOT STAND BEHIND THE MUFFLER ON FIRST OPERATION.**

**! DO NOT USE AUTOMOTIVE WHEEL CLEANERS OR ANY CLEANING PRODUCTS WHICH CONTAIN ACIDIC ADDITIVES TO CLEAN AKRAPOVIC EXHAUST SYSTEMS.**

#### **MAINTENANCE OF THE AKRAPOVIC EXHAUST SYSTEM**

1. Clean the titanium exhaust components with a multi-purpose spray lubricant (WD-40 or equivalent ), carbon fiber exhaust components with soft and dry cloth and stainless steel components with soft cloth sprayed with contact cleaner, then wipe with soft and dry cloth. Do not use aggressive chemical cleaners, because they can damage the sticker. A change in the color of the exhaust system is normal due to the high temperatures.
2. The wearing out of the muffler silencing material depends on the type of the engine and riding style. Contact your dealer/serviceman if visible changes appear on muffler's outer sleeve or the noise level is increased.
3. Periodically make sure all the bolts and springs are sufficiently tight.

# SUZUKI GSX-R 1000/ Complete exhaust system/ RACING LINE, model year: 2007 - 2008

Product code: S-S10R6-ZT  
S-S10R6-ZC

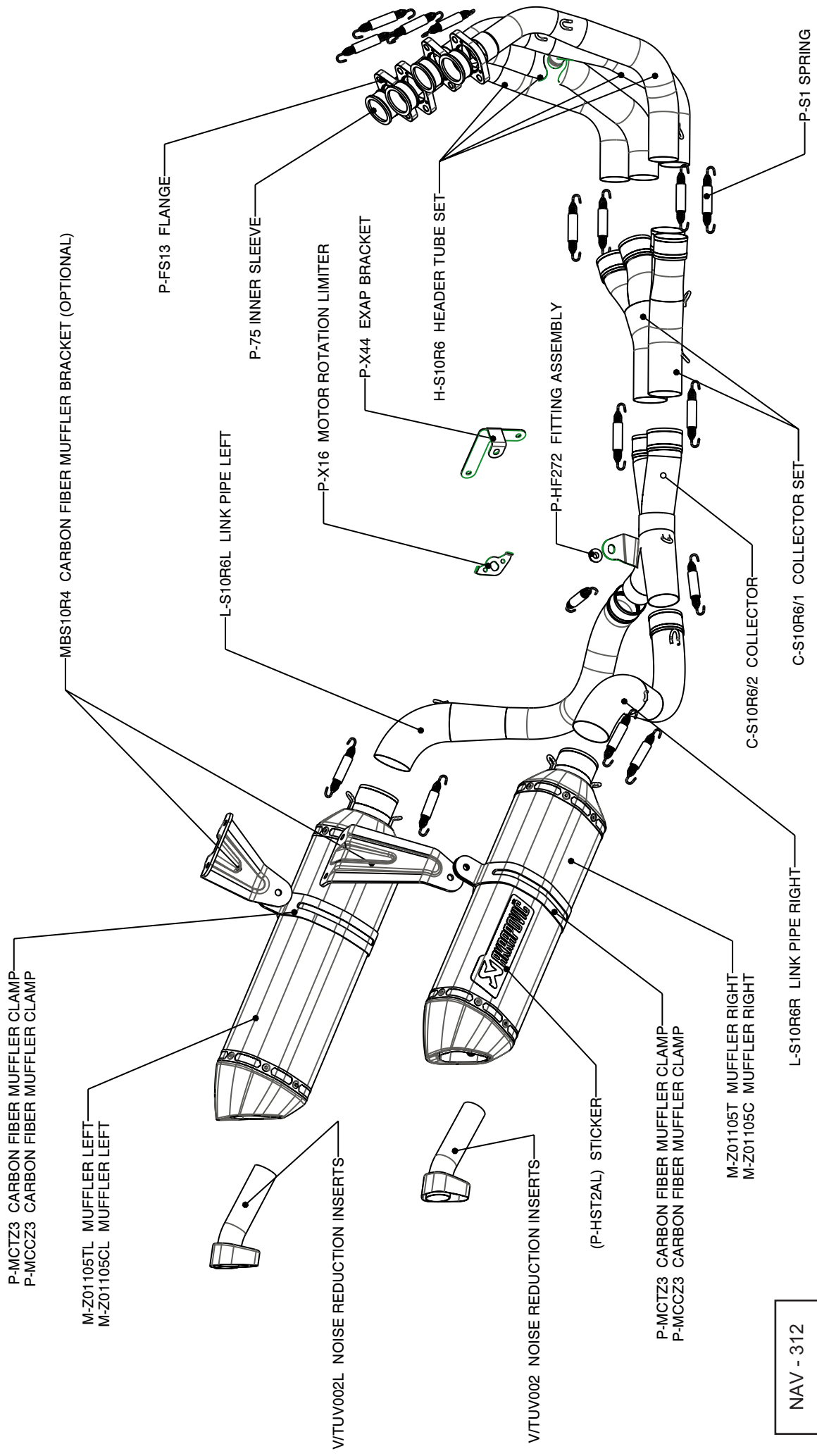

# SUZUKI GSX-R 1000/ Complete exhaust system/ EVOLUTION LINE, model year: 2007-2008

Product code: S-S10RFT6T-ZT  
S-S10RFT6T-ZC

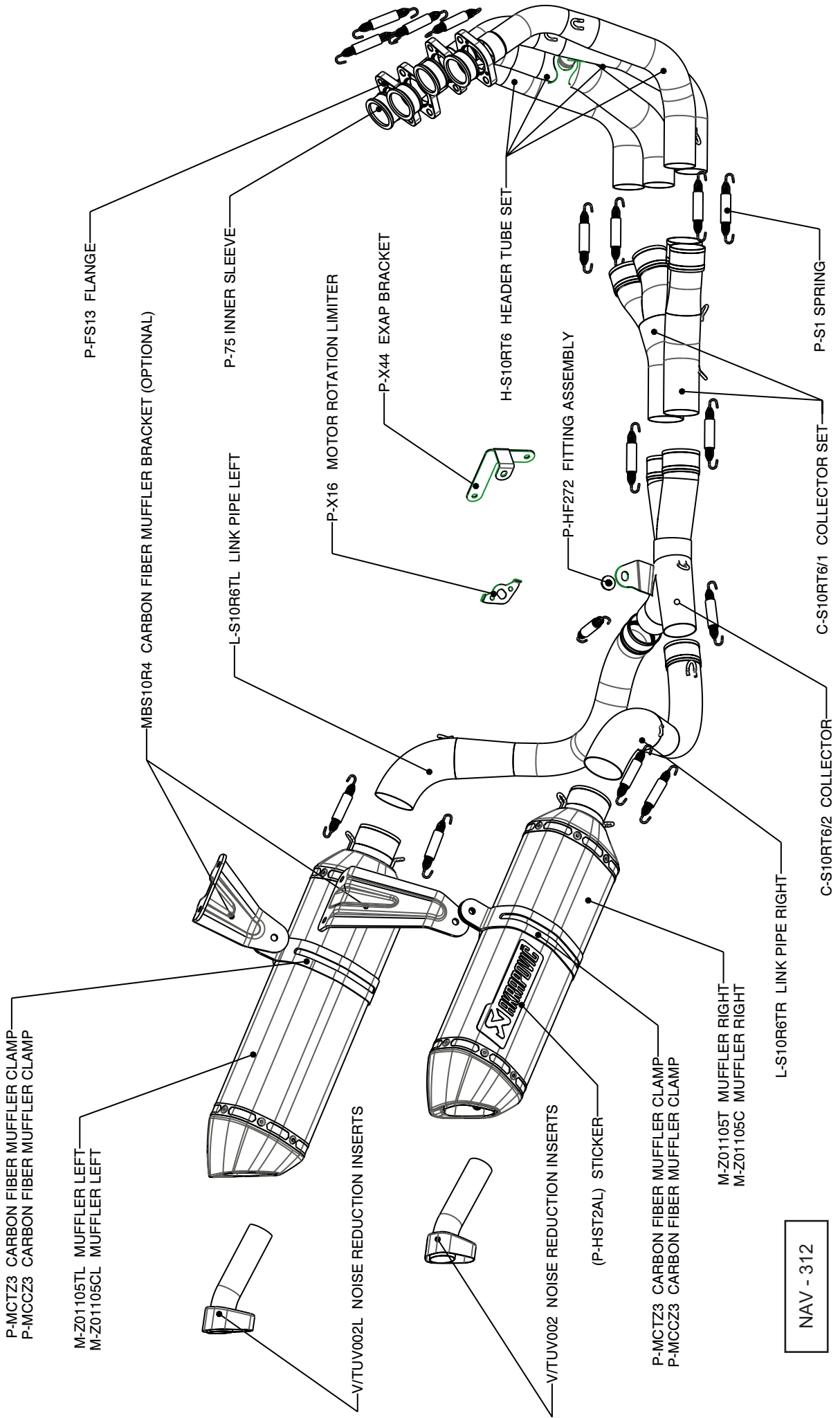

# SUZUKI GSX-R 1000/ Complete exhaust system/ EVOLUTION LINE, model year: 2007-2008

Product code: S-S10RFT6TL-XT

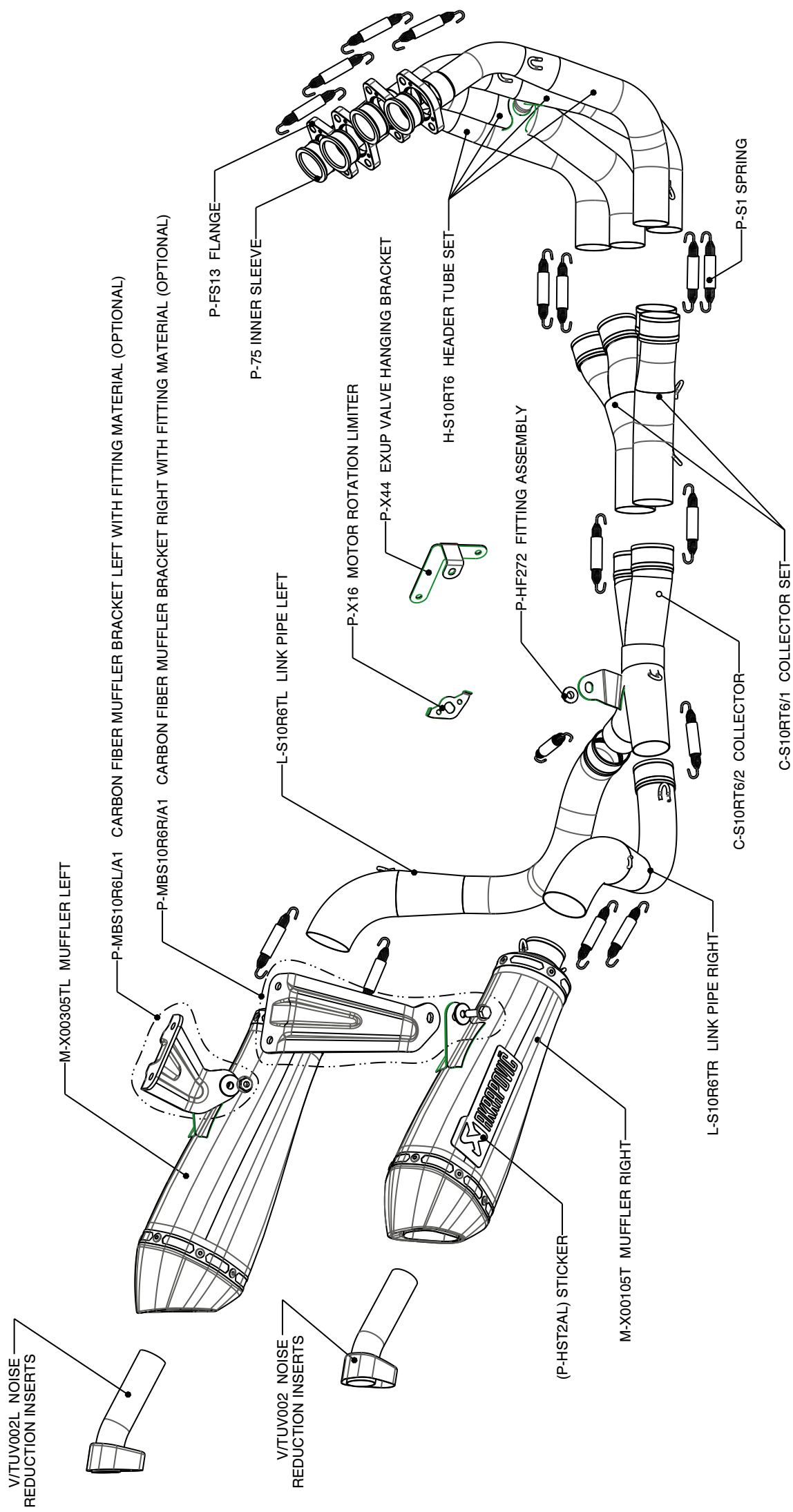



SUZUKI GSX-R 1000/ Complete exhaust system/ Racing line tube set with street legal Slip-on mufflers, model year: 2007 - 2008  
 SUZUKI GSX-R 1000/ Complete exhaust system/ Evolution line tube with street legal Slip-on mufflers, model year: 2007 - 2008

Product codes: S-S10R6-ZC/1  
 S-S10R6-ZT/1  
 S-S10RFT6T-ZC/1  
 S-S10RFT6T-ZT/1

WARNING! IN CASE OF COMBINATION WITH RACING OR EVOLUTION TUBE SET, THE SLIP-ON HOMOLOGATION IS NOT VALID!

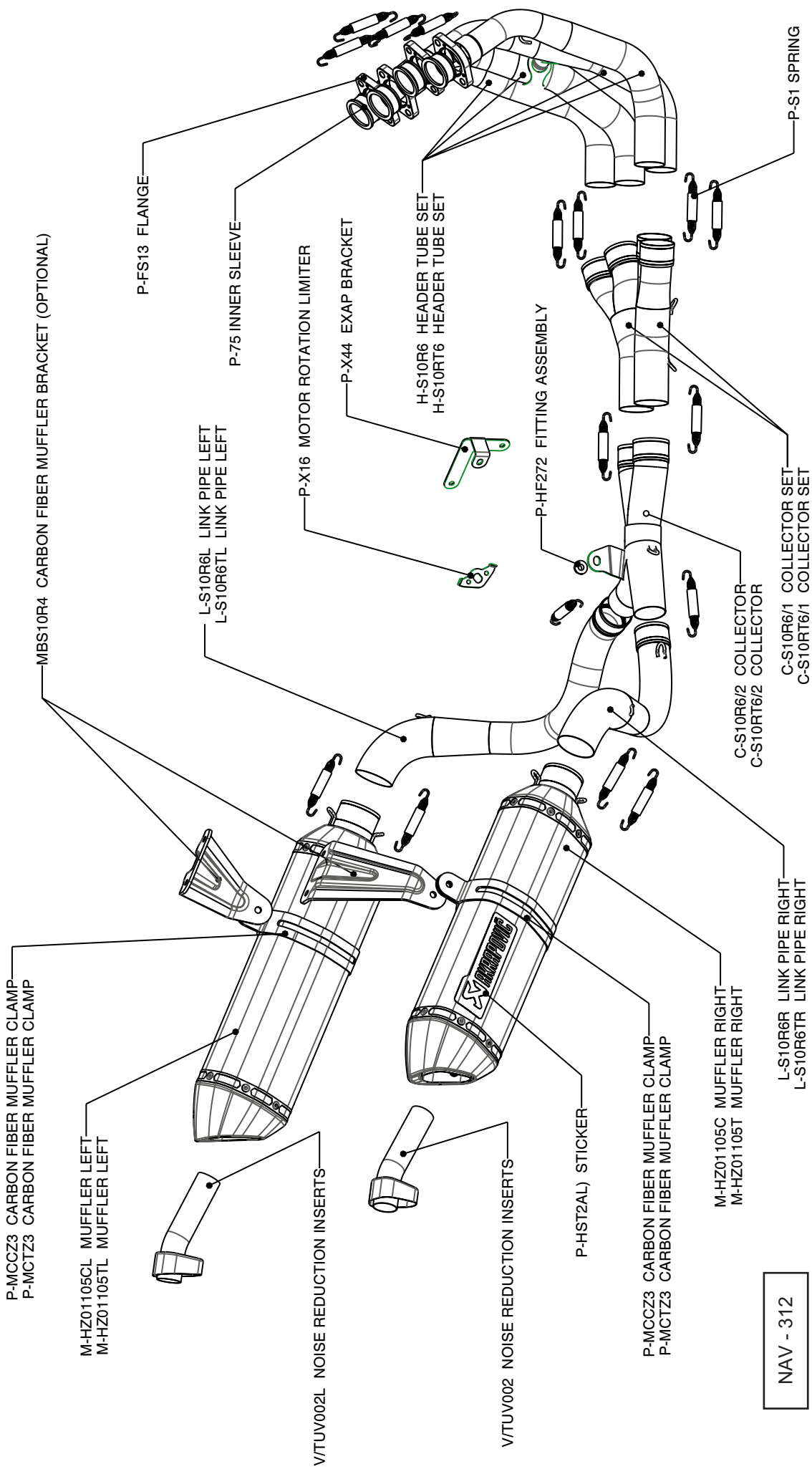

**WARNING:**

Please note that certain aftermarket exhaust systems may not comply with applicable California laws and regulations, and may therefore be prohibited for use on California highways or roads, or on roads or vehicles otherwise subject to emissions control requirements.

Akrapovič exhaust systems for automobiles and motorcycles mounted downstream of the catalytic converter (also known as “cat-back systems”) are considered “replacement parts” in California by the California Air Resources Board (CARB), and do not require an exemption or executive order from CARB to be sold in California. However, California prohibits the use of any aftermarket exhaust system that modifies, removes or replaces original equipment catalysts, unless CARB has issued an Executive Order as to such part or system.

Further, Akrapovič parts or exhaust systems used or intended for use on “racing vehicles” (i.e. a competition vehicle used exclusively for competition on closed-course circuits) do not require an exemption or Executive Order from CARB to be sold in California. However, such parts are prohibited from use on California public highways or roads, even if occasionally used “off-road.”